



June 8, 2005

RE: City of Thorp
2005 Industrial Park Roadway
Improvements
SEH No. ATHORW0501.00 14

DOT ID 8884-01-70

Lynn Cloud
BEES
P.O. Box 7965
Madison, WI 53707-7965

Dear Ms. Cloud:

The City of Thorp is proposing to improve existing streets within their existing Industrial Park. This project will be part of the TEA program and will require coordination with your office. Below is a project description along with a project location map, existing and proposed typical sections.

The existing industrial park roadways were constructed in 1987 and are approaching the end of their useful life. North Cemetery Street and East Nye Street consist of one 16-foot lane and one 12-foot lane with 30-inch curb and gutter on the west side and a 3-foot gravel shoulder on the East side. East Grant Street consists of two 17-foot lanes with 30-inch curb and gutter on the north side and 30-inch mountable curb and gutter on the south side. These streets are urban collectors of truck traffic that enter the industrial park and distribute products to the existing industries.

This existing reconstruction of streets is proposed due to deteriorating asphaltic surface caused by truck traffic, poor soils and over 18 years of useful service. The existing roadway improvements consist of pulverizing existing asphaltic material, reshaping and grading roadway and shoulders, spot repair of concrete curb and gutter, and repairing subgrade in specific areas of deterioration. Within these existing streets there are no environmental concerns at this time. Existing storm water will remain in place. WDNR will be contacted and proper permits will be applied for prior to construction and in accordance with Wisconsin Administrative Code NR 216.

Please review the above information and attached project location map to determine if a historical/archeological survey is required.

Sincerely,

SHORT ELLIOTT HENDRICKSON INC.

Todd Ochsner,
Community and Economic Development

Enclosure

x:\p\thorw050100\word\bees.doc

Short Elliott Hendrickson Inc., 421 Frenette Drive, Chippewa Falls, WI 54729-3374

SEH is an equal opportunity employer | www.sehinc.com | 715.720.6200 | 800.472.5881 | 715.720.6300 fax

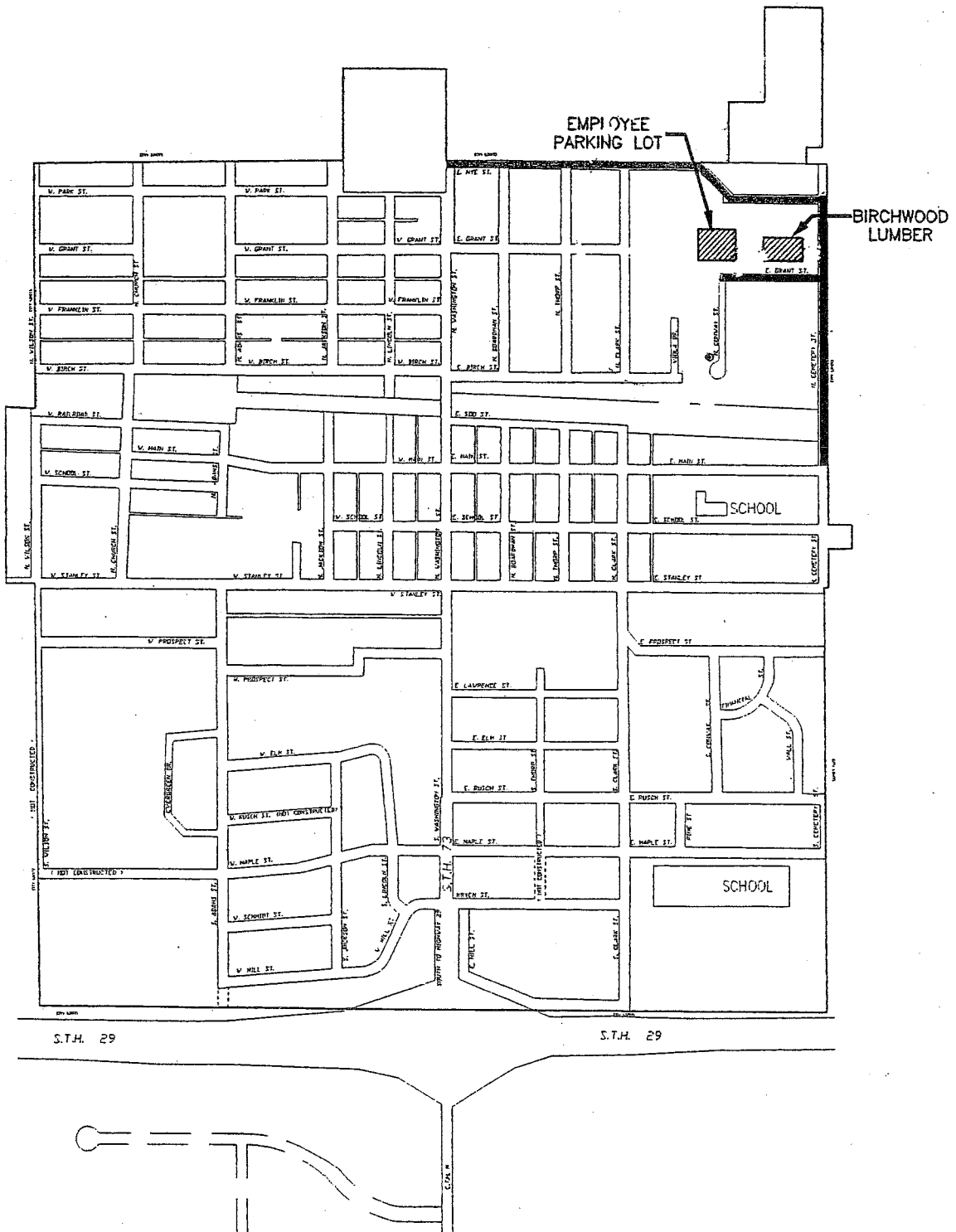

**CITY OF THORP
 PROPOSED TEA/SIB PROJECT
 BIRCHWOOD LUMBER
 12/15/04**

- EAST NYE
- E. GRANT RECONSTRUCTION
- E. GRANT EXTENSION
- N. CEMETERY ST. RECONSTRUCTION



0 500 1000

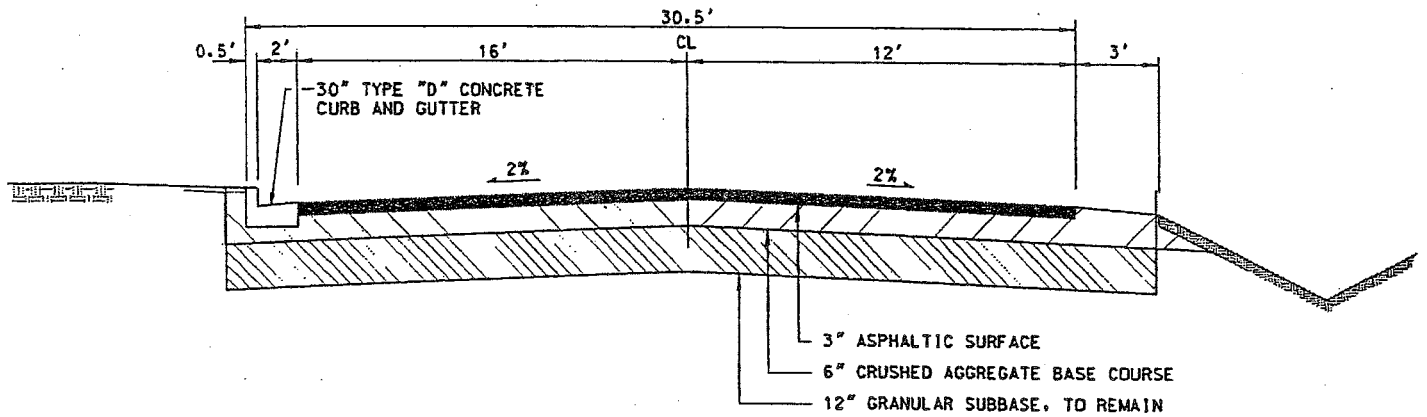

EXISTING SECTION
CEMETERY ROAD & EAST NYE STREET

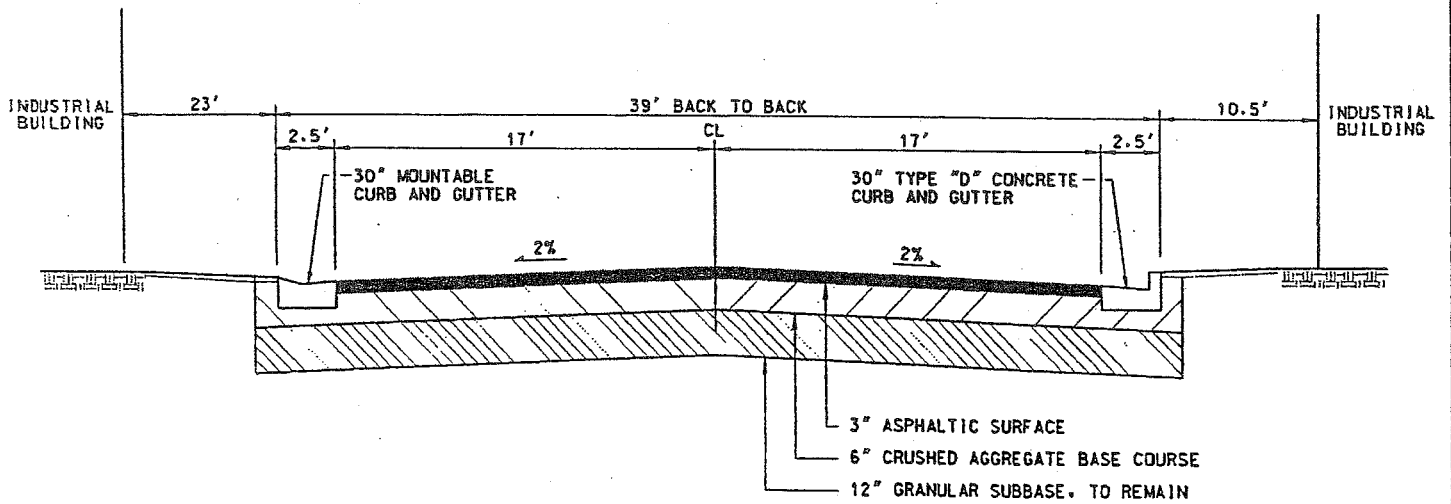

EXISTING SECTION
EAST GRANT STREET

DRAWING NAME: S:\PROJECTS\INDUSTRIAL PARK\RDWAY\SECTIONS.DWG

SEH
PHONE: 715.720.6200
421 FRENETTE DRIVE
CHIPPEWA FALLS, WI 54729

INDUSTRIAL PARK
ROADWAY IMPROVEMENTS
THORP, WISCONSIN

TYPICAL SECTIONS

FILE NO.
THORW0501
DATE
10/22/04

1
3

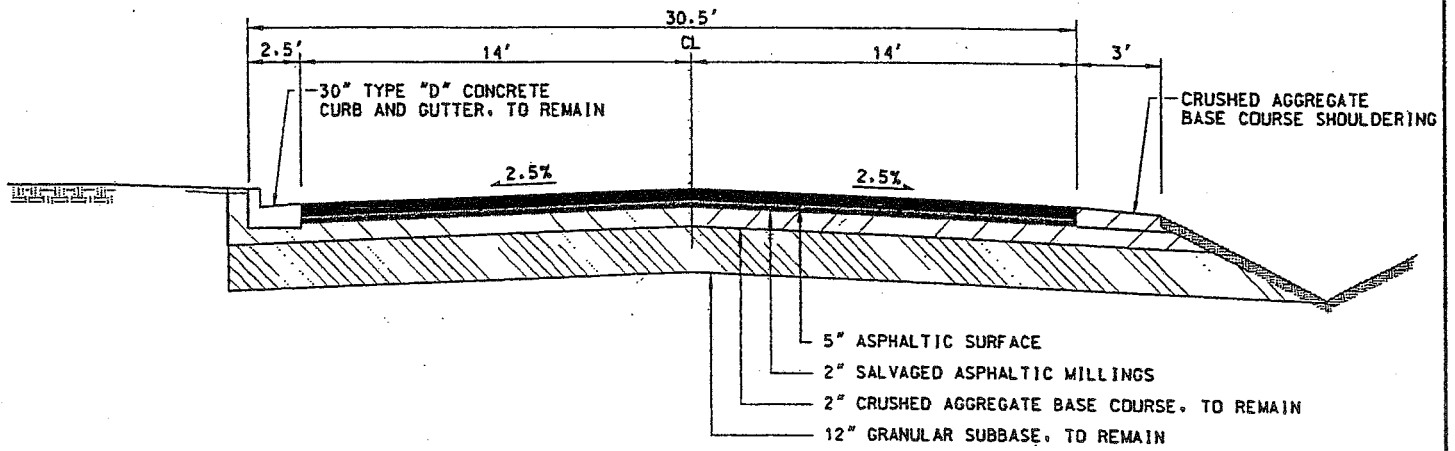

PROPOSED SECTION
CEMETERY ROAD & EAST NYE STREET

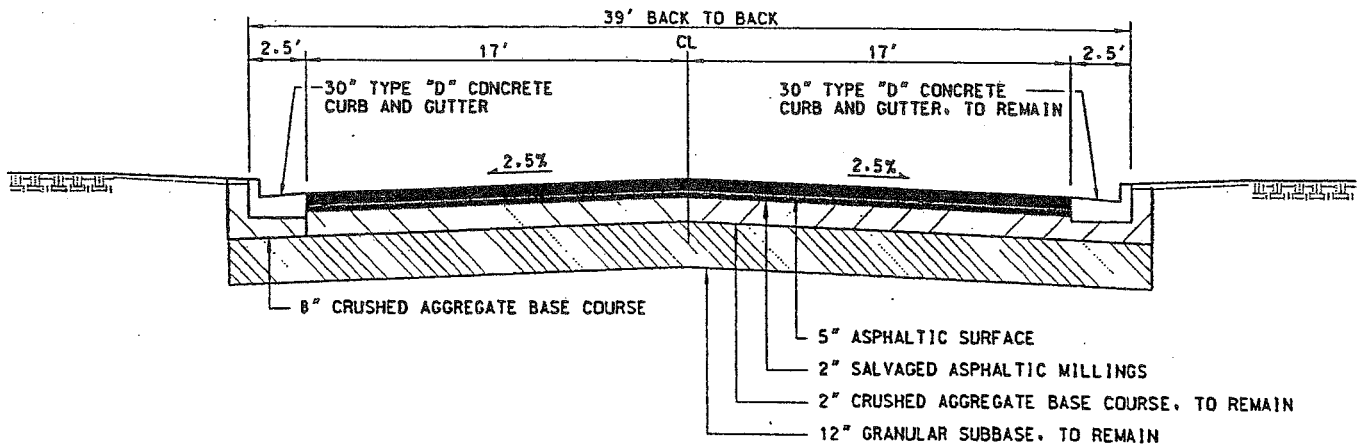

PROPOSED SECTION
EAST GRANT STREET

DRAWING NO. 14-PTV1001A-RSBI-BRODERMAN-SECTIONS.DWG

SEH
 PHONE: 715.720.6200
 421 FRENETTE DRIVE
 CHIPPEWA FALLS, WI 54729

INDUSTRIAL PARK
 ROADWAY IMPROVEMENTS
 THORP, WISCONSIN

TYPICAL SECTIONS

FILE NO.
THORW0501
DATE
10/22/04

2
3